



22SN0072 – Pineapple Haven, LLC

Magisterial District – Clover Hill

Applicant – **Malikan Forde** (804-787-4364)

CPC Public Hearing – **October 18, 2022**

Time Remaining

100 Days

Case Manager

Harold Ellis

(804-768-7592)

Request

Conditional Use

A family day care home is proposed.

Staff Recommendation

Deferral

The Property

11833 Rimswell Turn

Site Size

0.32 Acre

Comprehensive Plan –

Land Use Designation

Suburban Residential II

Plan Area

County Wide Plan

Figure 1: Aerial of Request Area – Click Image for Link to GIS



Figure 2: Area Map of Request & Land Use Plan Map



Summary of Proposal

Request for a conditional use to permit a family day care home, incidental to a dwelling, in a Residential (R-12) District. The applicants propose to allow the keeping of up to twelve (12) children from the home. This is the applicant's initial request on the Property.

Deferral:

The District Commissioner recommends deferral of this case to the Commission's regularly scheduled November 15, 2022 public hearing in order to allow the applicant additional time to finalize details of this request.

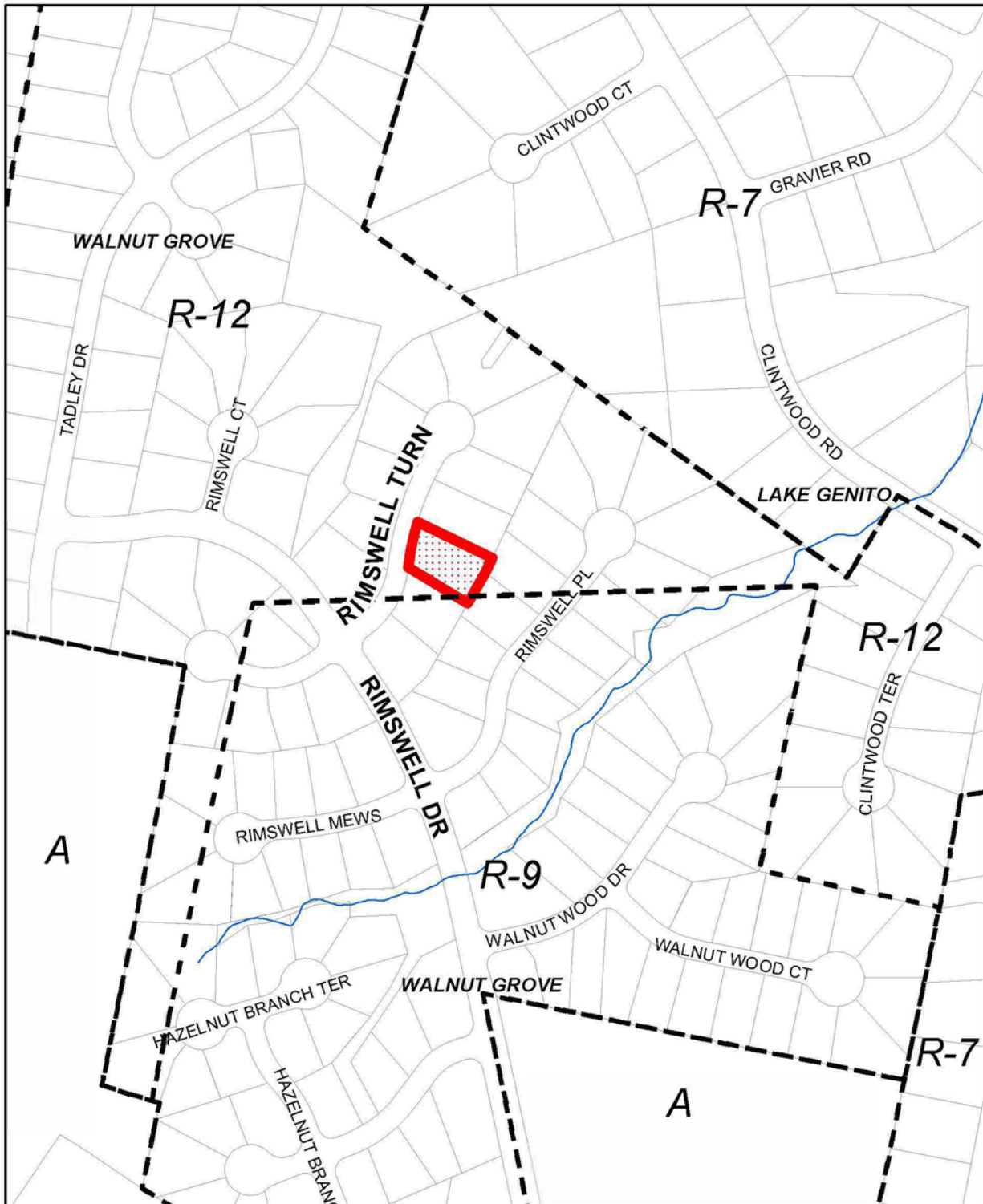

Current Zoning Map



Map 1: Subject Property

Case #: 22SN0072
Acreage: 0.32
Address: 11833 RIMSWELL TURN
GPIN: 741-687-6761



 Resource Protection Area
 Streams